

Junction Boxes for Self-Regulating Heating Cables

Designed for connecting self-regulating electric heating cables to the power network and for branching of self-regulating heating cables*.

Box models are supplied in 2 installation variants:

- complete with a pipe installation stand UVK for direct mounting onto the surface of a pipeline or tank;
- for installation onto a wall, onto a nearby metal structure or using a bracket directly onto the pipeline (brackets supplied separately).

Features

- Efficient solution for power supply and input of self-regulating heating cables connection through thermal insulation in electric heating cable systems
- Compatible with all types of self-regulating electric heating cables
- Excludes the risk of damage to heating cables at connection points
- Approved for installation in explosion hazard areas

The enclosure design ensures moisture and dust ingress protection IP66 and high corrosion stability. Cable gland of the box is intended for connecting unarmoured power cables with a diameter of 7 to 18 mm or armored power cables with a diameter of 12 to 20 mm.

The installed terminal blocks allow the connection of multi-core or single-core wires with a cross-section of 1.5 to 10 mm². Design options with screw or push-in terminals are available to order.

- Critical components are included in the scope of supply. Metal pipe strap PFS/3, cable entry unit and flexible sealed gland FSG to be ordered separately
- Wide application range
- Quick and easy installation
- High thermal stability
- Non-corrosive

Application Areas

The box allows connection of up to three self-regulating electric heating cables to the power cable and connection of up to three cables for branching.

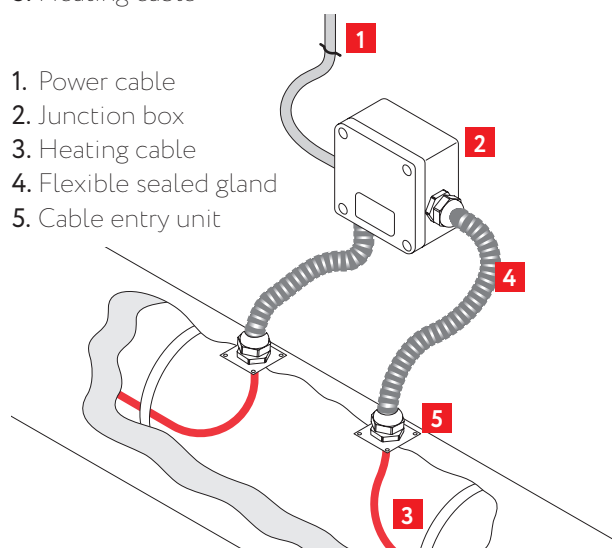
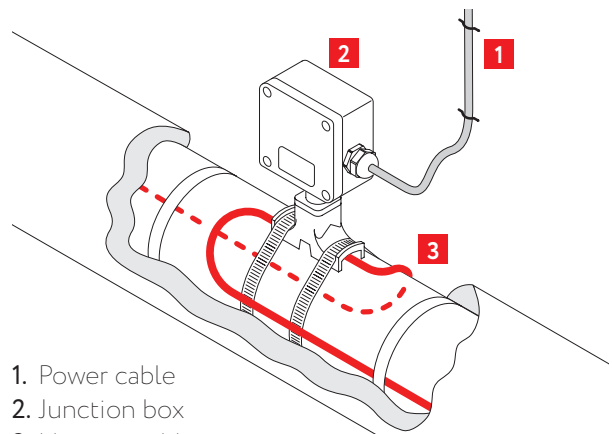

* This junction box is compatible with self-regulating heating cables HTM, HTA, HTP, BTC, BTX, CTE.

Power Supply of Self-Regulating Heating Cables

Technical Data

Dust and moisture protection rating	IP66
Explosion protection marking	Ex eb IIC T6...T3 Gb Ex tb IIIC T85°C... T165°C Db
Temperature group of the explosion hazard area	T6
Operating ambient temperature range	-60...+55 °C
Operating voltage	max 550 V
Operating current	max 50 A
Enclosure dimensions JB 2221-223	122×120×91.5 mm
Total weight (maximum)	1.55 kg
Material Box / Color	Glass fiber reinforced polyester / Black
Material Pipe installation support / Color	polyester / Black

Construction

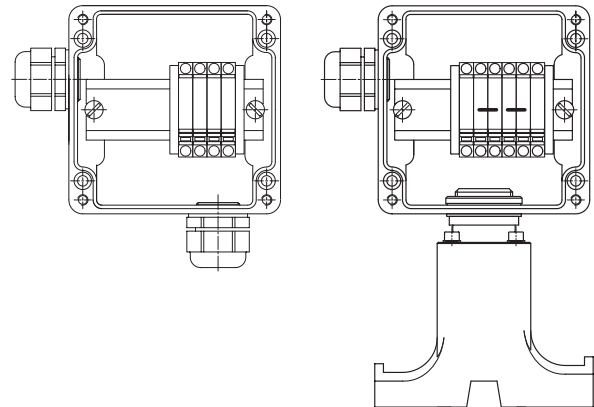

Quantity, type of terminals and placement of DIN-rail with terminal block could differ from drawings.

Delivery Set

Model	Cable glands and plugs (P=plastic; B=brass)								Earthing tag	Terminated earthing wire	Pipe installation support	Terminal block	Type of terminals	Order code
	Side A		Side B		Side C		Side D							
	Cable gland	Screw plug	Cable gland	Screw plug	Cable gland	Screw plug	Cable gland	Screw plug						
JB2221-223-2X340°			1xM25 P		1xM25 P							1L, 1N, 2PE	screw/ push-in	3210001612
JB2221-223-2X350				1xM25 P	1xM25 P									3210001613
JB2221-223-2X360			3xM25 P		1xM25 P							3L, 3N, 3PE		3210001614
JB2221-223-2X370				3xM25 P	1xM25 P									3210001615
JB2221-223-1X300					1xM25 P					V		2L, 2N, 2PE		3210001603
JB2221-223-1X310						1xM25 P				V				3210001604
JB2221-223-1X11						1xM25 P		V	V	V				3210002006
JB2221-223-1X12					1xM25 B			V	V	V				3210002008
JB2221-223-1X13					1xM25 P			V	V	V				3210002010
JB2221-223-2X11			1xM25 P		1xM25 B		1xM25 P	V	V			2L, 1N, 2PE/ 3L, 2N, 2PE		3210002012
JB2221-223-2X12			1xM25 P		1xM25 B		1xM25 P	V	V					3210002013
JB2221-223-2X13			1xM25 P		1xM25 P		1xM25 P	V	V					3210002014
JB2221-223-2X14			1xM25 P		1xM25 P		1xM25 P	V	V					3210002015
JB2221-223-2X15			1xM25 P		1xM25 B		1xM25 B	V	V					3210002016

Order codes are valid for junction boxes with push-in terminal block.
Additional configurations are available upon request.

° X = 1 for screw type terminal block; X=2 for push-in type terminal block